

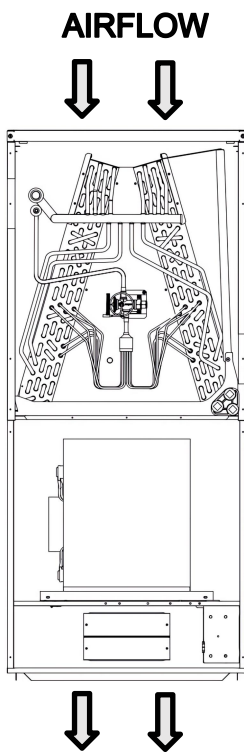

Making your home Green & Smart

# Downflow Kit Installation Guide



Down Air Flow Diagram

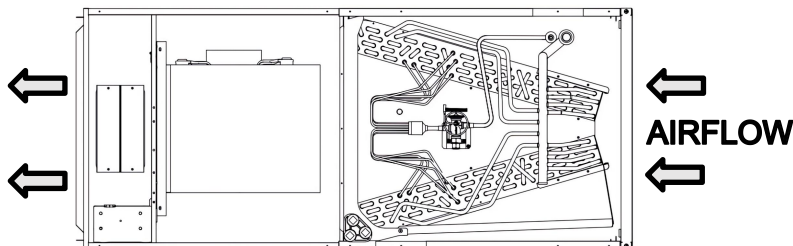

Horizontal Left Air Flow Diagram

## ! WARNING

Disconnect all power to unit before installing or servicing. More than one disconnecting switch may be required to de-energize the equipment. Hazardous voltage can cause server personal injury or death.

**ALL phases of this installation must comply with NATIONAL, STATE AND LOCAL CODES**

**IMPORTANT** — This Document is **customer property** and is to remain with this unit. Please return to service information pack upon completion of work.

## DESCRIPTION

The Downflow kit is a metal component installed between the coil and the water tray. By installing the Downflow kit, the airflow direction of the unit can be configured to be downward or horizontal left.

The Downflow kit is depicted below.

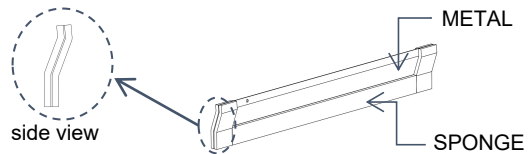

Downflow Kit

## PARTS LIST FOR KITS

Item	Qty.
Sheet metal bar	2
Installation Guide	1

**The steps for installing the kit are as follows:**

**Step 1:** Prepare two Downflow kits. Remove the coil and insert the Downflow Kit between the coil and the drain pan.

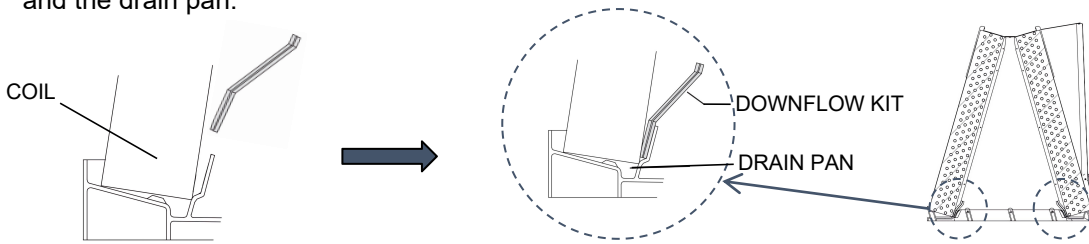

**Step 2:** Apply sealant to the four corners of the drain pan and coil.

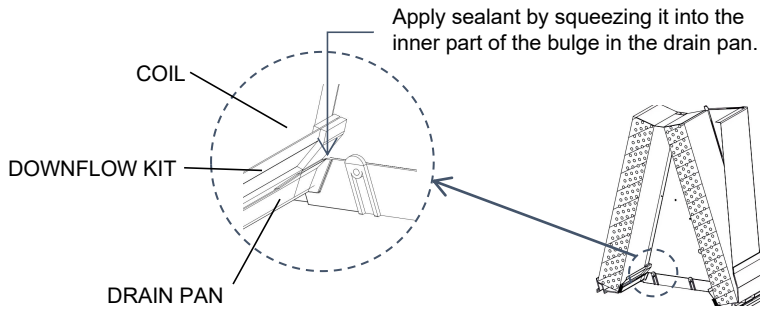

**Step 3:** Reassemble the coil back into the unit.

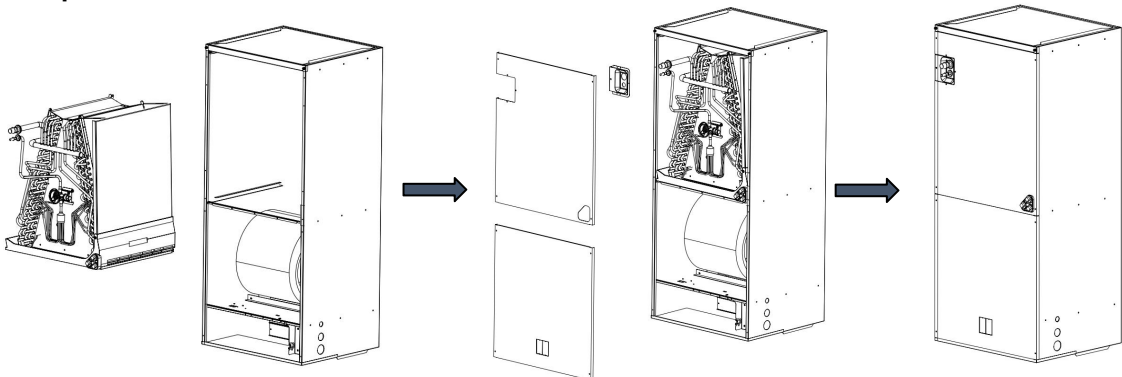

The Downflow Kit can also be used to achieve the airflow direction in a horizontal left application. Simply install a Downflow Kit on the top, and apply sealant to the two corners of the drain pan and coil on the side where the Downflow Kit is installed.

