

## FG7SA

### Single Stage Upflow/Horizontal and Downflow Gas Furnaces

**Induced Draft - 80+ AFUE**  
**Input 54,000 - 108,000 Btuh**

The gas furnace may be installed free standing in a utility room, basement, or enclosed in an alcove or closet. The rounded corner jacket provides a pleasing “appliance appearance.” Design certified by UL.



### FEATURES and BENEFITS

- **100% fired and tested:** All units and each component are tested on the manufacturing line.
- **Best packaging in the industry:** Unique corner post design assures product will arrive to the homeowner dent free.
- **Low Boy Height:** Easy to apply in low ceiling applications, works well with taller high SEER coils, easier to handle and install.
- **Tubular primary heat exchanger:** Heavy gauge aluminized steel heat exchanger assures a long life.
- **20 second blower delay at start-up:** Assures a warm duct temperature at furnace start-up. Adjustable blower off settings (60, 90, 120 and 180 seconds).
- **45 second post purge:** Increases life of heat exchanger.
- **Hot surface igniter:** Innovative application of a silicon nitride igniter.
- **Color coded wire harness:** Designed to fit the components, all with quick-connect fittings for ease of service and replacement.
- **High static blowers:** All models equipped with high static blowers.
- **40 second cooling cycle blower-off delay (TDR):** increases cooling performance.
- **Flexible category I venting system:** May be vented with dedicated venting system or common vented with other category one appliances.
- **Multi-speed direct drive blower:** Energy-efficient, brushless DC (ECM). Designed to give a wide range of cooling capacities. Dip switches on PCB provide easy motor speed selection.
- **LP convertible:** Simple burner orifice and regulator spring change for ease of convertibility.
- **Integrated control board:** Incorporates connections for electronic air cleaner and humidifier. Ergonomically located for ease of service.
- **Two piece door design:** Enhances furnace appearance and uses captured screws to prevent losing door screws.
- **Blower Compartment:** Insulated for ultra quiet operation.
- **Furnace Air Leakage:** These furnaces comply with Energy Star cabinet air leakage requirement of less than or equal to 2%. Keep the conditioned air flowing to where it's needed.

# GAS FURNACE COMPONENTS

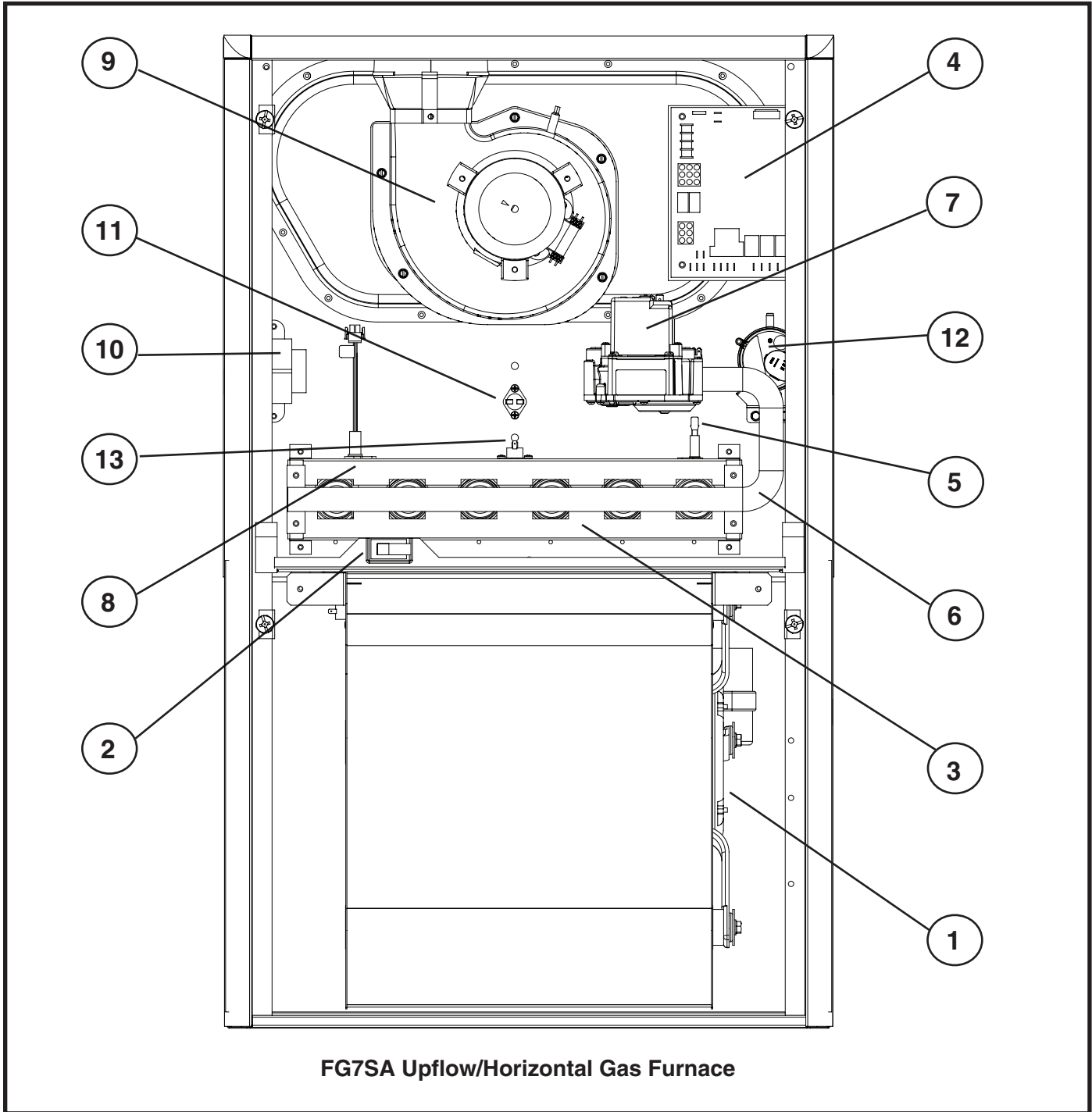

FG7SA Upflow/Horizontal Gas Furnace

- |                       |                             |                           |
|-----------------------|-----------------------------|---------------------------|
| 1. Blower Assembly    | 6. Gas Manifold             | 11. Main Air Limit Switch |
| 2. Blower Door Switch | 7. Gas Valve                | 12. Pressure Switch       |
| 3. Burner Assembly    | 8. Igniter                  | 13. Roll-Out Switch(s)    |
| 4. Control Board      | 9. Inducer                  |                           |
| 5. Flame Sensor       | 10. Low Voltage Transformer |                           |

# DIMENSIONS

| FG7SA Model #'s | Dimension "A" | Dimension "B" | Dimension "C" | Dimension "D" |
|-----------------|---------------|---------------|---------------|---------------|
| 054-23A         | 14 1/4        | 10 3/4        | 12 5/8        | 12 7/8        |
| 072-24B         | 17 1/2        | 11 3/4        | 15 7/8        | 16 1/8        |
| 090-24B         |               |               |               |               |
| 090-35C         | 21            | 14            | 19 3/8        | 19 7/8        |
| 108-35C         |               |               |               |               |

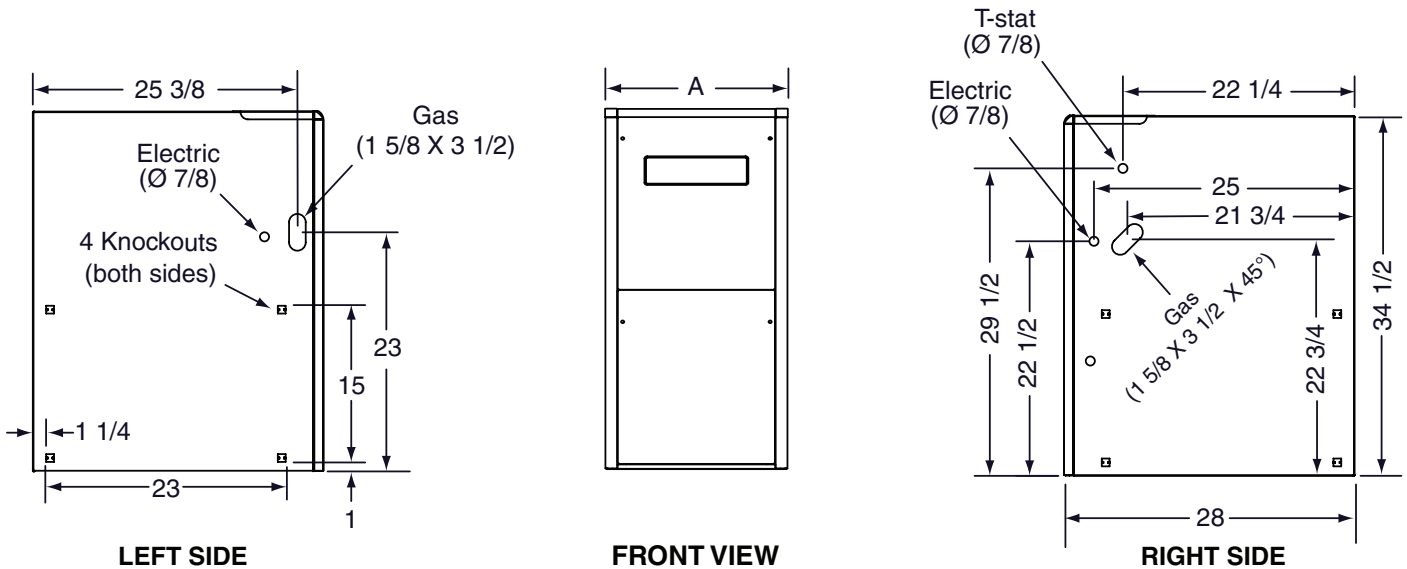
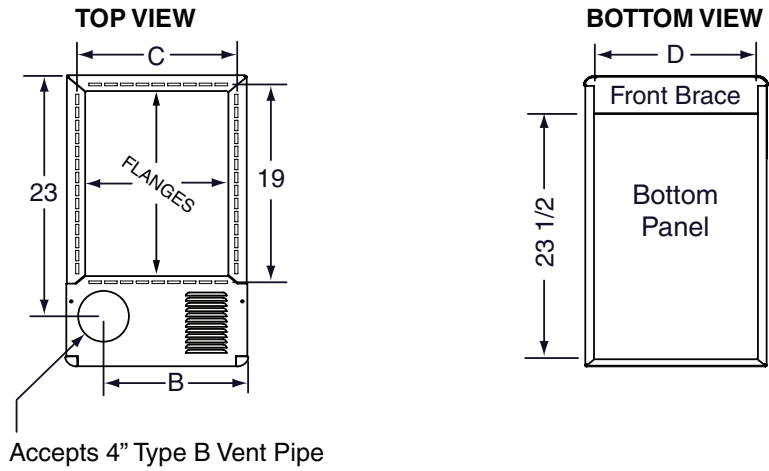

**FG7SA Single Stage Upflow/Horizontal Series**

## MODEL IDENTIFICATION CODE

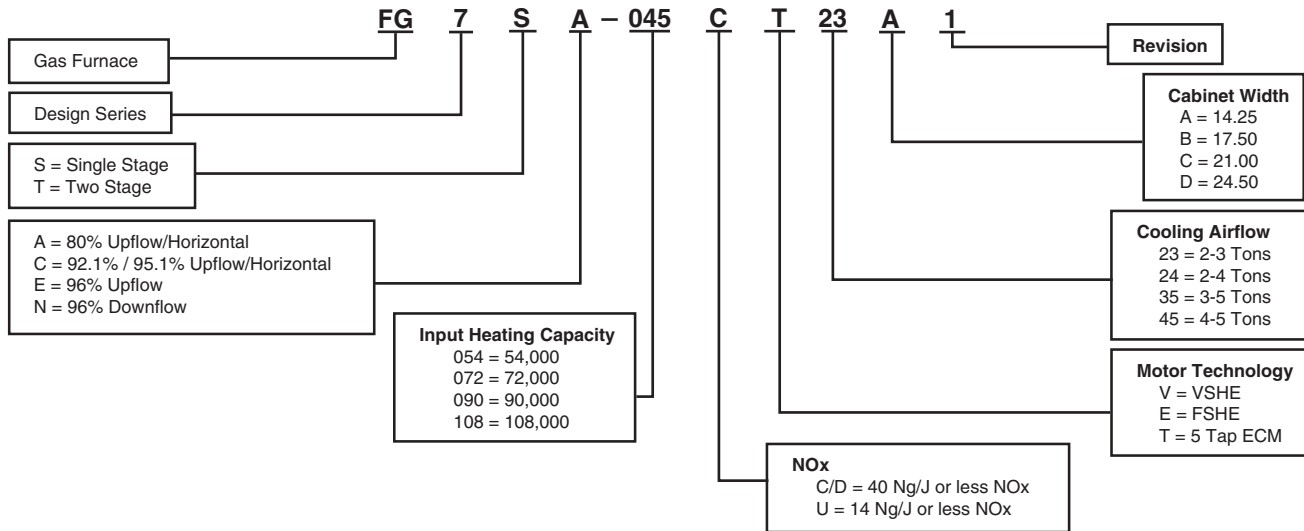

## SPECIFICATIONS

| FG7SA MODEL NUMBERS         | -054-T23A1    | -072-T24B1    | -090-T24B1    | -090-T35C1 | -108-T35C1 |
|-----------------------------|---------------|---------------|---------------|------------|------------|
| Input - Btuh (a)            | 52,000        | 70,000        | 90,000        | 85,000     | 108,000    |
| Heating Capacity - Btuh     | 42,000        | 56,000        | 72,000        | 68,000     | 86,000     |
| <b>AFUE</b>                 | 80.0          | 80.0          | 80.0          | 80.0       | 80.0       |
| Motor H.P. - Speed - Type   | 1/2 - 5 - ECM | 3/4 - 5 - ECM | 3/4 - 5 - ECM | 3/4-5-ECM  | 1-5-ECM    |
| Motor FLA                   | 6.4           | 8.8           | 8.8           | 8.8        | 11.5       |
| Rated Ext. SP - In. W.C.    | 0.5           | 0.5           | 0.5           | 0.5        | 0.5        |
| Temperature Rise Range - °F | 30-60         | 30-60         | 35-65         | 35-65      | 35-65      |
| Shipping Weights            | 95 lbs        | 110 lbs       | 115 lbs       | 134 lbs    | 136 lbs    |

## ACCESSORIES

| FG7SA KITS  |        |
|---|--------|
| Description   | SKU    |
| U.S. LP Conversion kit (0 to 10,000 ft.) and High Altitude LP | 905028 |



Before purchasing this appliance, read important energy cost and efficiency information available from your retailer. Specifications and illustrations subject to change without notice and without incurring obligations. (05/2024)

### GENERAL TERMS OF LIMITED WARRANTY

Ecoer Inc. will furnish a replacement for any part of this product which fails in normal use and service within the terms and conditions of the warranty. For complete details of the Limited Warranty, including applicable terms and conditions, see your local installer or contact the Ecoer Inc. warranty department for a copy. Visit <https://www.ecoer.com/warranty/>; to get the latest warranty information.